



Company	Model	Date	Version
 Wanbao 万宝	ENB150	2017.3.23	A

Refrigerator compressor

technical specification

Model	ENB150	Customer	
Author		Standardized By	
Examiner		Approver	

Company	Model	Date	Version
 Wanbao 万宝	ENB150	2017.3.23	A

General

Compressor model	ENB150
Refrigerant	R600a
Approvals	CCC/CB/VDE
Compressors on pallet	72

Application

Application	LBP	
Evaporating temperature range	°C	-35 to -15
Voltage range	V/Hz	220~240/50
Max. ambient temp.	°C	43
Comp. cooling at ambient temp.	32°C	S
	38°C	S
	43°C	S

S = Static cooling normally sufficient
O = Oil cooling
F₁ = Fan cooling 1.5m/s
(compressor compartment temperature equal to ambient temperature)
F₂ = Fan cooling 3.0m/s necessary

Design

Displacement	cc	15.1
Oil quantity	cc	280±10
Oil viscosity	mm ² /s@40°C	4.5~6.5
Free Gas Volume	cc	/
Weight without electrical equipment	kg	11.0±0.3

Motor

Motor type	RSCR		
Resistance, (20 °C)	main winding ±10%	Ω	9.19
	Start winding ±10%	Ω	13.86
Max. winding temperature continuous	°C	130	

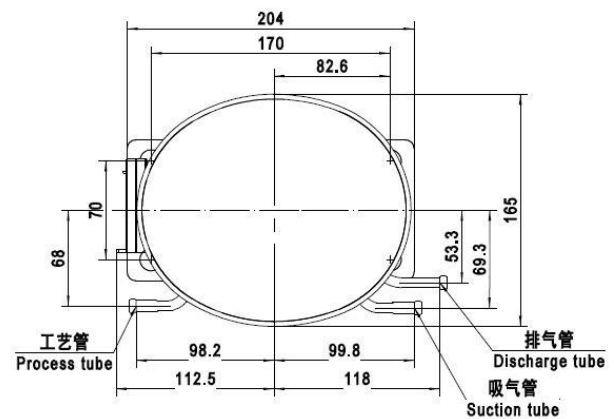
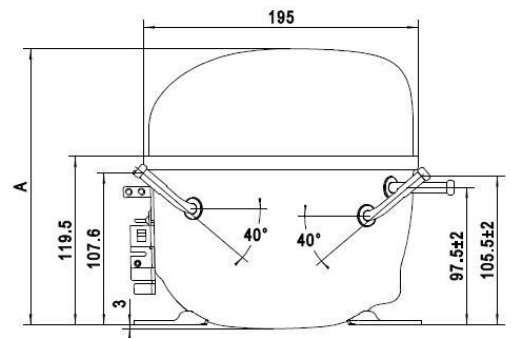

Company	Model	Date	Version
 Wanbao 万宝	ENB150	2017.3.23	A

Dimensions

Height (A)	mm	193±3
Suction tube	I.D. mm	Φ6.1-Φ6.2
Process tube	I.D. mm	Φ6.1-Φ6.2
Discharge tube	I.D. mm	Φ4.9-Φ5.0

* Process tube and suction tube is NOT exchangeable. (pls see indication of sticker)

Performance data (ASHRAE)

Voltage range	Cooling Capacity (watt)	Input power (watt)	Working current (A)	COP (W/W)
220V/50Hz	258	143.3	0.72	1.80

Test conditions	ASHRAE
Condensing temp.	54.4 °C
Evaporating temp.	-23.3 °C
Ambient & suction gas temp.	32.2 °C
Subcooling temp.	32.2 °C



Accessories

Relay-model	TY-QZ-003	
Basic resistance 25°C	Ω	15±20%
Trip time	S	0.2~1.2
Reset time	S	≤80
Max. working voltage	V	300
Max. working current	A	8
OLP-model	BT62-120	
Trip Current(25°C)	A	6.2
Trip time	S	6~16
Reset time	S	≥30
Trip temp.	°C	120±5
Reset temp.	°C	61±9
Actuating Current(70°C)	A	1.30~1.70
Capacitor type	Run capacitor	
Capacity	μF	5

